

2
Planta baixa - praça p2
1:100

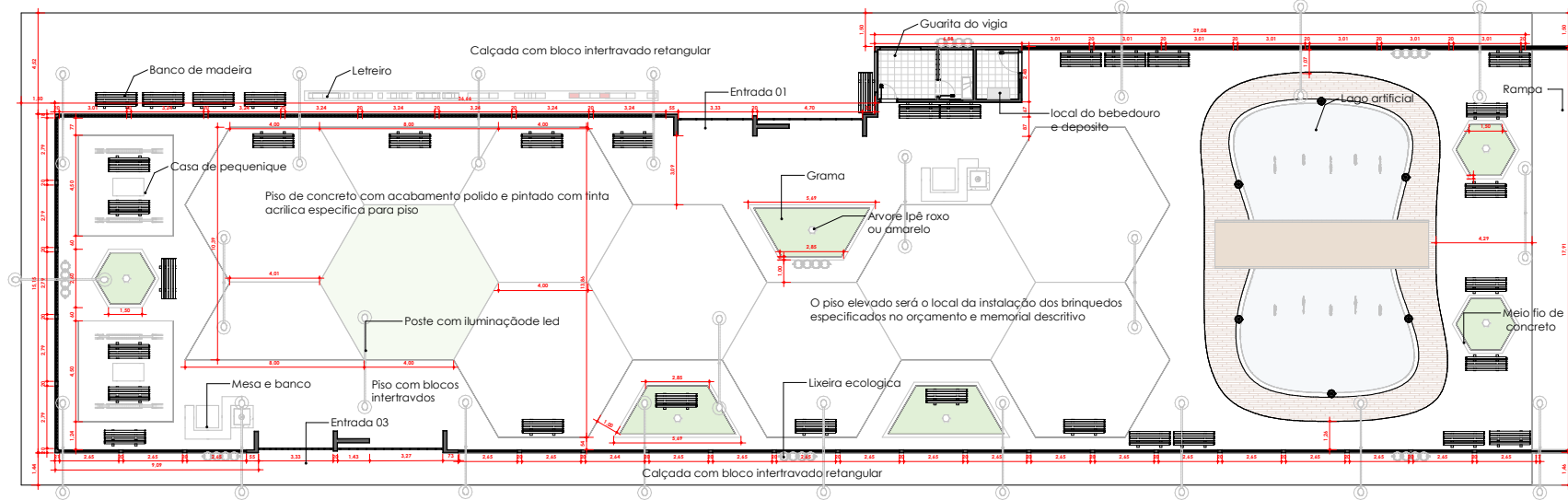

1
Planta baixa - Praça p1
1:100

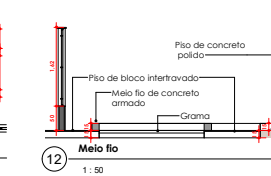
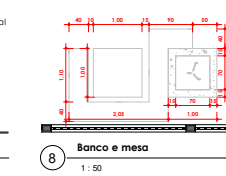
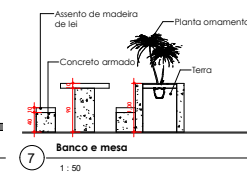
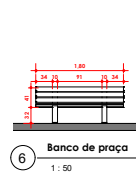
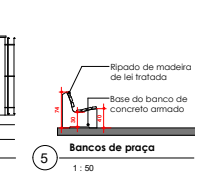
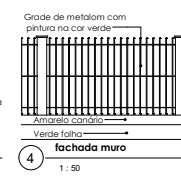
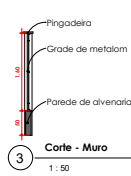
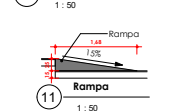
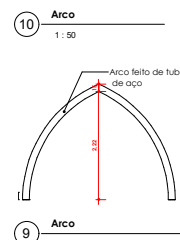
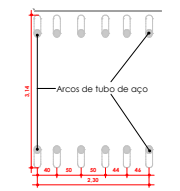

PREFEITURA MUNICIPAL DE VITÓRIA DO XINGU
SECRETARIA MUNICIPAL DE OBRAS
DEPARTAMENTO DE ENGENHARIA E ARQUITETURA

PROJETO ARQUITETÔNICO

ASSUNTO: CONSTRUÇÃO DA BRINQUEDOLÂNDIA
 PROJ.ET.: ENG.º CIVIL GABRIEL SOUZA DE ALMEIDA
 END. OBRA: AVENIDA MANOEL FELIX DE FARIAS

ESCALA: INDICADA
 FOLHA: ARQ
 DATA: 06

PAP.EL: A1